

Williamston Barns – Log Burner Instructions.

We are providing these instructions as a number of guests have asked us the best way to light the log burner. We hope that this is useful.

Initial lighting – as the flue is cold we suggest that you burn some newspaper before laying the fire. After lighting the newspaper relay with more newspaper and kindling. Once going well add logs as required. (Note position of air vent in figure 9)

5. Lighting the Appliance

5.1 For best results set air controls as shown, see Diagram 9.

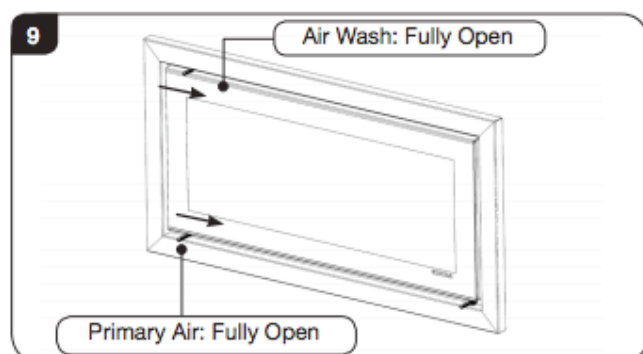

5.2 Place firelighters or paper and dry kindling wood on the base bricks.

A successful fire initially requires plenty of kindling to establish a hot firebox and warm the chimney to aid flue performance.

5.3 Light the paper or firelighters, see Diagram 10.

5.4 Leave the door slightly open as the fire establishes and the glass warms to avoid build up of condensation.



5.5 Add larger pieces of wood.
Do not use full sized logs at this stage, build up gradually in size. Too many logs may smother the fire.

6. Running the Appliance

Burning Wood

6.1 Close the **Primary air control** and use the **Airwash** to control the burn rate when appliance is at operating temperature, see Diagram 12.

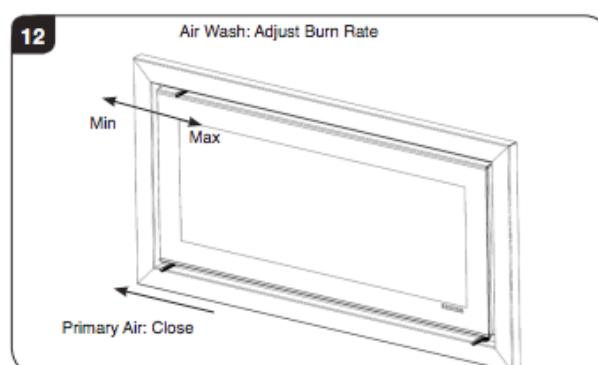

Wood burns best on a bed of ash (approx. 25mm (1") deep).

6.2 Do not burn large amounts of fuel with the **Airwash Control** closed for long periods of time. This reduces the glass cleaning effect of the Airwash and causes tars and creosotes to build-up in the appliance and flue system.

6.3 When in use, burning the appliance at a high temperature for a short period reduces tars and creosotes.
WARNING: DO NOT OPERATE THE APPLIANCE WITH THE PRIMARY AIR CONTROL OPEN FOR LONG PERIODS OF TIME AS THIS COULD CAUSE OVER-FIRING AND MAY CAUSE PERMANENT DAMAGE.

Experience establishes settings to suit personal preference.

Refuelling

6.4 Open the Primary Air and Airwash controls fully.

Rake the embers evenly over the firebed to establish a glowing firebed. If the firebed is low add a small amount of kindling wood to help re-establish the fire.

6.5 Do not refuel when a large amount of flames are in the firebox as this could cause smoke or flames to spill into the room.

6.6 Close the doors immediately after refuelling.

These are wide appliances and the logs should be laid out in a single layer with gaps between, see Diagram 11.

Do not stack the logs on top of each other as this could effect the efficiency.
DO NOT OVERLOAD THE APPLIANCE AS TOO MUCH FUEL COULD CAUSE IT TO OVER-FIRE.